

HYDRAULIC FLARELESS FITTINGS

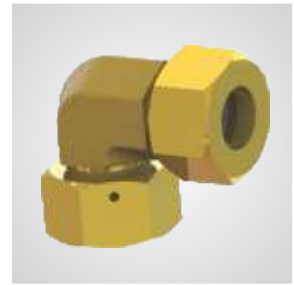
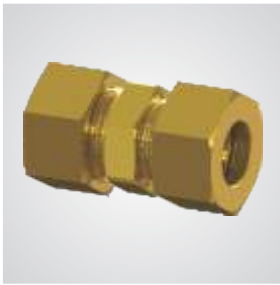

HYDRAULIC FLARELESS FITTINGS AND SINGLE FERRULE FITTINGS (DIN 2353, ISO 8434-1)

TMI manufactures 24° bite type hydraulic fittings according to the norms of DIN 2353. The TMI hydraulic fitting consists of three parts : body, ferrule or weld nipple and nut. The heart of the TMI fitting is the design of the hardened ferrule which “bites” into the pipe to provide a leak-proof joint. The unique action of the ferrule provides for a strong, vibration resistant joint which can withstand repeated dismantling and re-assembly. TMI hydraulic fittings are available for Fractional and Metric tubes and are offered in a variety of materials depending upon area of application.

TMI RANGE OF HYDRAULIC FITTINGS

Tube to tube (Equal Fittings) :

Both ends are tube and the assembly is with Ferrule/Weld Nipple. The joint is made by assembly of fittings with ferrule. A Weld Nipple can be used instead of a ferrule when it is required to join two pipes of an equal size.

Tube to Threads (Male/Female) :

These fittings are generally known as “stud” couplings.

Tube to Swivel :

During installation, when a swivelend is needed to fit with a fixed line, a special swivel nut is provided which can revolve around the body but will not disengage. Swivel connections are also available.

Banjo Fittings :

These are used for high pressure applications and provide a 360° rotation facility. These fittings are mainly used for positioning the tube fitting line. The perforated hollow shaped bolts directly on the end pass through the spherical union body for fluid transfer.

Adaptors :

Used to connect fittings with instruments. TMI has a wide range of adaptors with different threads - Metric, BSP, BSPT, NPT.

Other Components :

Port reducers, Closing Plugs, Ferrules, Nuts, O rings, U rings, Elastomeric Rings.

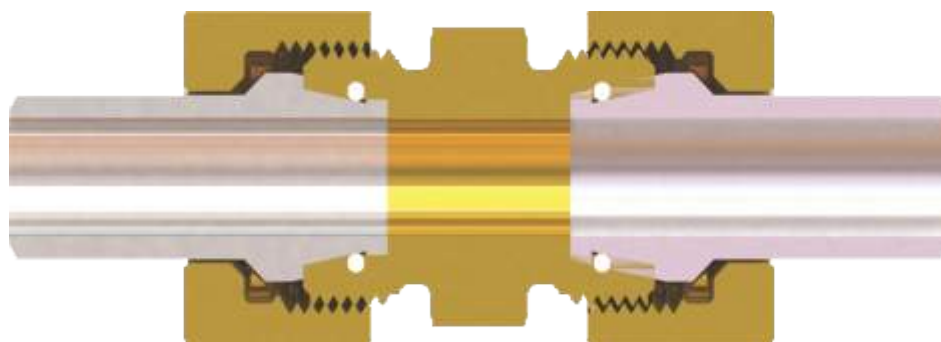

PRESSURE RATING AS PER DIN 2353

TMI fittings are available in Light, Medium and Heavy Series depending on the pipe size. Fittings with weld nipples are available only in Heavy Series.

TECHNICAL DATA

LL - Light Series	
100 Kg/cm ²	Tube OD 4 mm - 8mm
L - Medium Series	
250 Kg/cm ²	Tube OD 6 mm - 15 mm
160 Kg/cm ²	Tube OD 18 mm - 22 mm
100 Kg/cm ²	Tube OD 28 mm - 42 mm
S - Heavy Series	
630 Kg/cm ²	Tube OD 6 mm - 14 mm
400 Kg/cm ²	Tube OD 16 mm - 25 mm
250 Kg/cm ²	Tube OD 30 mm - 38 mm

THREADING INFORMATION

MEDIUM SERIES (L)										
Tube OD	6	8	10	12	15	18	22	28	35	42
BSP/NPT/ BSPT METRIC	1/8", M10X1	1/4", M12X1.5	1/4", M14X1.5	3/8", 1/4", M16X1.5	1/2", M18X1.5	1/2", M22X1.5	3/4", M26X1.5	1", M33X2	1 1/4", M42X2	1 1/2", M48X2

HEAVY SERIES (S)										
Tube OD	6	8	10	12	14	16	20	25	30	38
BSP/NPT/ BSPT METRIC	1/4", M12X1.5	1/4", M14X1.5	3/8", 1/4", M16X1.5	3/8", M18X1.5	1/2", M20X1.5	1/2", M22X1.5	3/4", M27X2	1", M33X2	1 1/4", M42X2	1 1/2", M48X2

ASSEMBLY PROCEDURE

- Cut the pipe at 90° and de-burr the inside & outside edges
- Lubricate the nut and the threads with oil
- Gently insert the nut and ferrule over the tube end and ensure they are facing the right direction
- Insert this assembly into the body and tighten the nut by hand until finger tight
- Mark the nut and tube and tighten for a ¾ turn. Check the assembly – the pipe should be held fast. Tighten a further ¾ turn to achieve the ferrule “Bite” into the pipe
- During dismantling and re-assembly, mark the position of the nut in relation with body before disconnecting the joint. Re-assemble by tightening with a wrench and ensure that the nut comes to its original position in relation with body. Then tighten until slightly rise in torque is felt.

TUBE TO TUBE

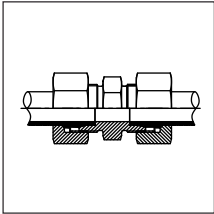

SU Straight Union

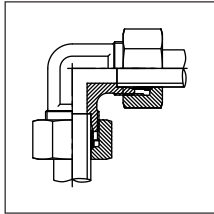

EU Equal Elbow

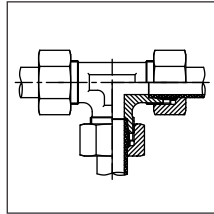

TU Equal Tee

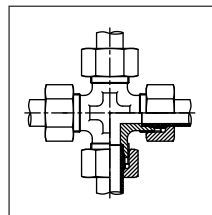
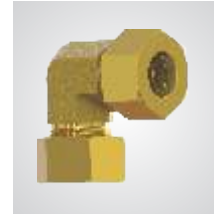

KU Equal Cross

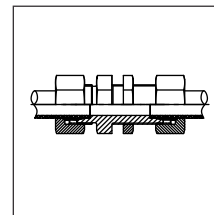

SBU Straight Bulk
Head Coupling

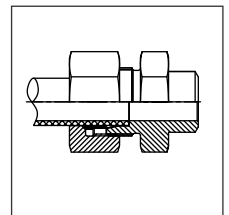

WC Weld Coupling

TUBE TO TUBE

Adapter Fittings (M-Metric, R-BSP)

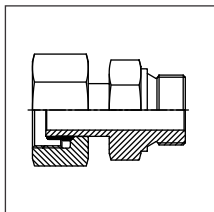

SPA-M / SPA-R
Stand Pipe Adapter

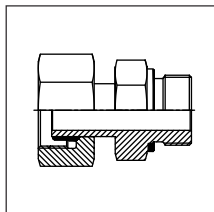

SPA-M-es / SPA-R-es
Stand Pipe Adapter with
Elastomeric Seal

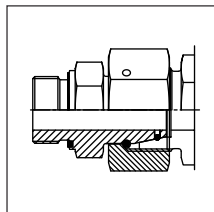

SAO-M-es / SAO-R-es
Straight Stud Adapter
with Elasto. Seal, Swivel Nut



Stud Coupling (M-Metric, R-BSP)

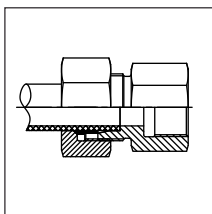

SFU-M / SFU-R
Straight Female Stud
Coupling

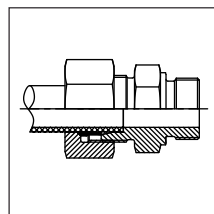

SMU-M / SMU-R
Straight Male Stud
Coupling

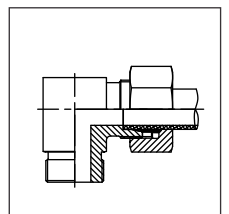

MEC-M / MEC-R
Male Stud Elbow
Coupling

Stud Tee Fittings (M- Metric, R- BSP, Rx-BSPT, N-NPT)

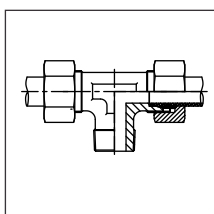

MBT-M / MBT-R
Male Stud Branch Tee

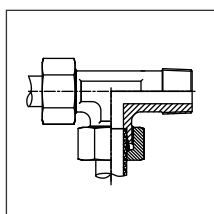

MRT-M / MRT-R
Male Stud Run Tee

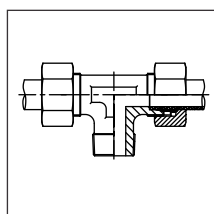

TMBT-Rx / N
Taper Male Stud
Branch Tee

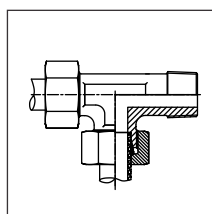

TMRT-Rx / N
Taper Male Stud
Run Tee



SWIVEL FITTINGS

Swivel Elbow Fittings (M-Metric, R-BSP)

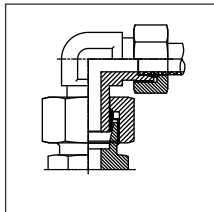

SWE
Swivel Elbow

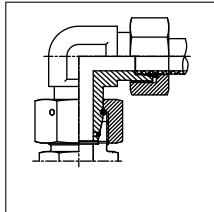

SWEO
Swivel Elbow with
O ring

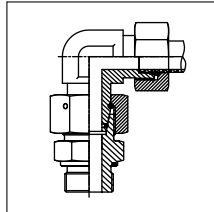

SWEOC-
Mes/SWEOC-Res
Swivel Elbow with
O ring and Connector

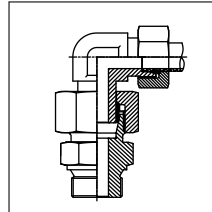

SWEC-M/SWEC-R
Swivel Elbow with
Connector



Swivel Tee Fittings (M-Metric, R-BSP)

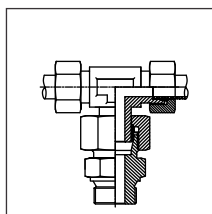

SWBTC-M/ SWBTC-R
Swivel Branch
Tee Connector

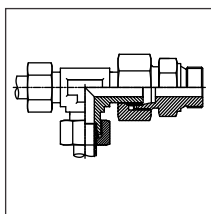

SWRTC-R
Swivel Run
Tee with Connector

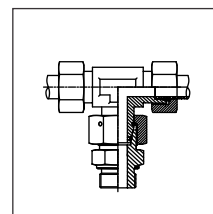

SWBTC-
Mes/ SWBTCOC-Res
Swivel Run Tee with
O ring & Connector

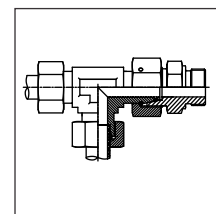

SWRTCOC-
Mes/ SWRTCOC-Res
Swivel Branch Tee with
O ring and Connector

BANJO CONNECTORS

Banjo Fittings (M-Metric, R-BSP)

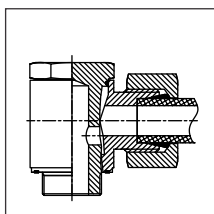

SWBC-M/ SWBC-R
Swivel Banjo
Elbow Connector

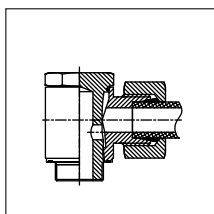

HSWBC-M/ HSWBC-R
High Pressure Elbow
Banjo Connector

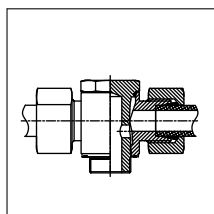

HSWTBC-M/ HSWTBC-R
High Pressure Tee
Banjo Connector



REDUCING ADAPTOR & WELD NIPPLE



HA
Hose Adaptor

RTA
Reducing Thread
Adaptor

RTAes Reducing
Thread Adaptor with
elastomeric seal

WN
Weld Nipple

Adaptors are available in male, female and male-female combinations and in sizes as per the chart below :

OPTIONS	1 / 8 "	1 / 4 "	3 / 8 "	1 / 2 "	3 / 4 "	1 "	1 1 / 4 "	1 1 / 2 "
1/8 "		✓	✓	✓				
1/4 "	✓		✓	✓	✓			
3/8 "	✓	✓		✓	✓			
1/2 "	✓	✓	✓		✓	✓	✓	✓
3/4 "		✓	✓	✓		✓	✓	✓
1 "		✓	✓	✓	✓		✓	✓
1 1/4 "				✓	✓	✓		✓
1 1/2 "				✓	✓	✓	✓	

Weld Nipple Fittings are available as per client requirements and tube size. Reducing Weld Nipple Adaptors can also be supplied.

SWRTOC-25Res-SS : Swivel Run Tee 'O' ring, Connector & Elastomeric Seal

SWRTOC

—

25

—

S

—

R

—

es

—

SS

Type of
Fitting

Pipe
OD

Pressure
Series

Threads
Type

Sealant
Type

Material
Type

Material Code for Ordering

No Code

S

SL

SS

SSL

SST

B

es

Carbon Steel

Stainless Steel 304

Stainless Steel 304L

Stainless Steel 316

Stainless Steel 316L

Stainless Steel 316Ti

Brass (Is319)

Elastomeric Seal (Viton/Nitrile)



TECHNOMECH INTERNATIONAL

Registered Address: 102; Bldg 1, Opp Yamuna Nagar,
Oshiwara, Andheri - West, Mumbai - 400053

Corporate Address: 212, Heena Arcade Commercial
complex, Jogeshwari - West, Mumbai - 400102.
Telefax: 022-26788017

Direct Numbers:

+91-9967838972 | +91-7666982141
+91-8286006200 | +91-9619143766

Email: sales@technomechinternational.com
info@technomechinternational.com

Website: www.technomechinternational.com

